

SNAP

BLADE CHANGE SNAP5 / SNAP8 / SNAP12 / SNAP20

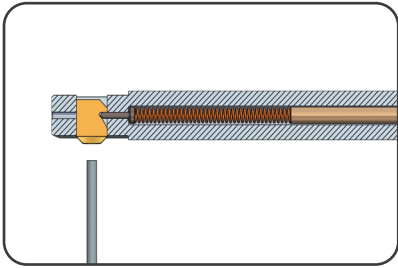

Tool SNAP12 with assembled blade.

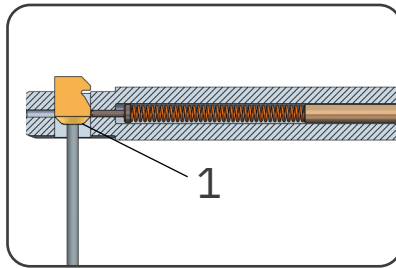

The SNAP blade can be pushed through the tool with an edgeless object. Put the aid on at the blade head (1).

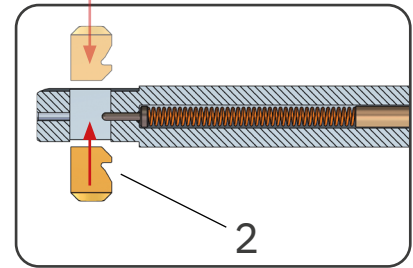

The deburring blade is pushed with its back first into the blade window of the tool until it engages. Please make sure that it is aligned with the recess (2) in the direction of the tool shank. The blade can be inserted into the tool from both sides.

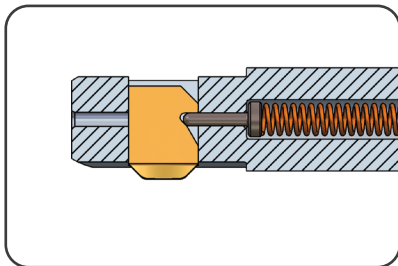

The control bolt has "snapped" into the blade recess. The tool is now ready for operation.