

SNAP

BLADE CHANGE SNAP2 / SNAP3 / SNAP4

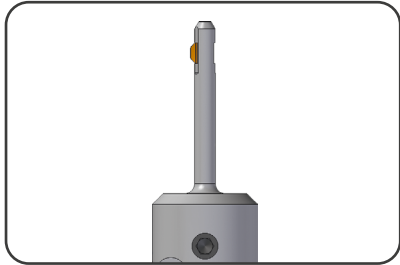

Tool SNAP12 with assembled blade.

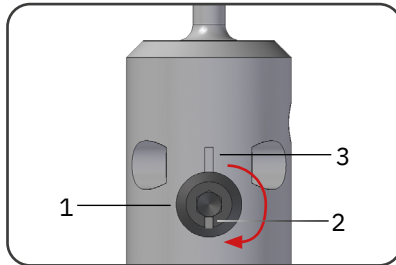

Turn excenter (1) by 180° until the groove of the excenter (2) is 180° opposite to the groove of the tool body (3).

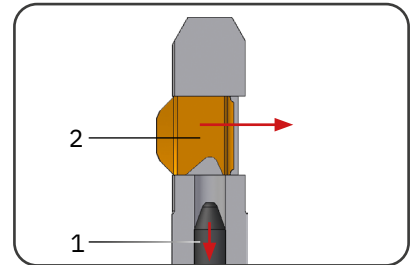

By the movement of the excenter, the control bolt (1) is pulled back out of the blade recess. Then the blade (2) can be easily pushed out in the indicated direction.

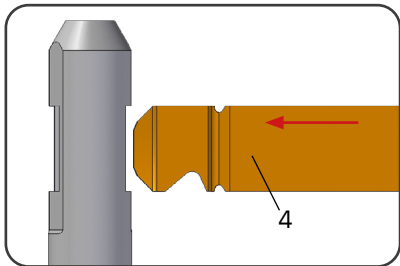

When mounting a new blade with integrated assembly aid (4), please make sure to insert the blade with the cutting geometry first into the blade housing.

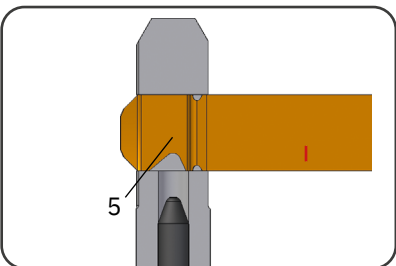

Push the blade so far that the control recess of the blade (5) is over the bolt cross bore. As an optical aid, the cutting geometry should be visible to the full extent on the other side of the blade housing.

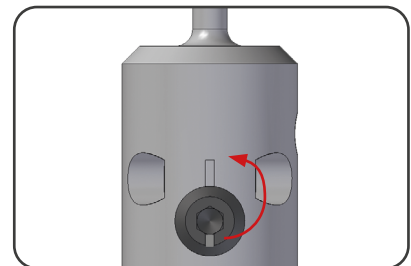

Turn back the excenter by 180° until the groove of the excenter is aligned with the groove in the tool body.

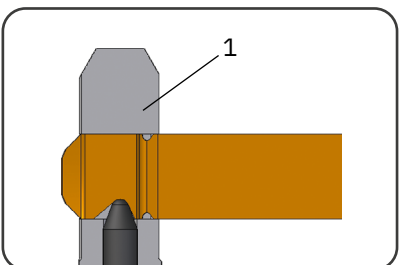

By turning back the excenter, the control bolt moves forward into the control recess of the blade.

1) Predetermined breaking point

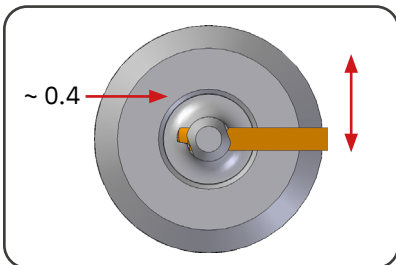

Remove assembly aid of the blade by pushing back the blade by approx. 0.4mm until the predetermined breaking point is in line with the edge of the blade window. Then break off assembly aid by using thumb and index.

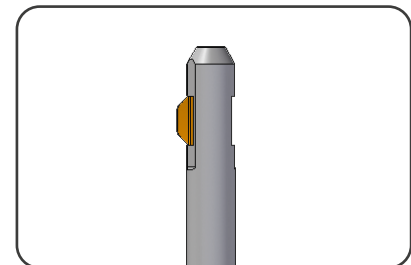

The blade moves back to the starting point as soon as it is released.