

SNAP18 MODULE

ASSEMBLY OF MODULE INTO DRILL BODY

Explanation individual parts

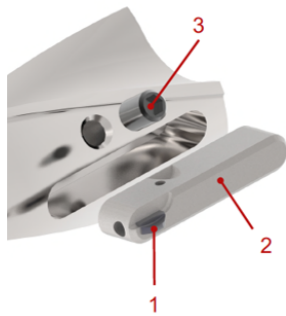

- 1** Blade
- 2** SNAP18 Module (referred as "module" in the following instructions)
- 3** Fixing screw M3 (with loosening lock)

Caution:

Replace the fixing screw after each module disassembly (blade exchange).

Mounting

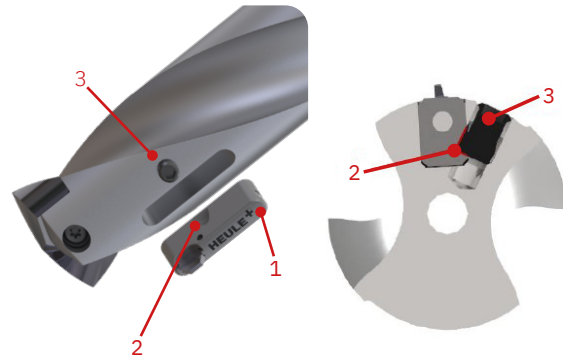

Insert the module with the mounted blade (**1**) into the drill body – the cutting edge faces the drill tip, and the screw clearance (**2**) is aligned with the screw position. Fully tighten the fastening screw (**3**) until it bottoms out and secure it with 1.5 Nm.

Mounted modul



Check:

The screw (**3**) must not protrude; otherwise, the module is incorrectly installed.

Recommended assembly tool

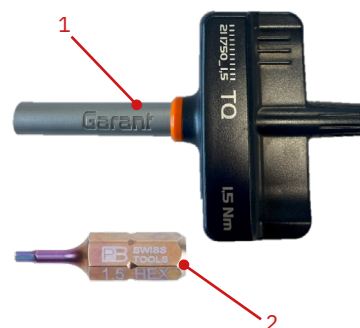

Option 1:

Torque screwdriver, fixed setting
1.5 Nm



Option 2:

PrecisionBit for hexagon, 1/4 inch
C 6.3, 1.5 mm

