

SNAP18 MODULE

BLADE CHANGE – INSERTION

Assembly fixture LIGHT

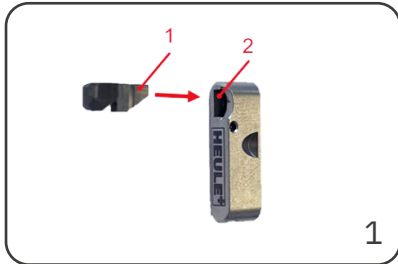

Push the blade with the mounting aid (1) ahead from the front side (HEULE logo) into the blade window (2).

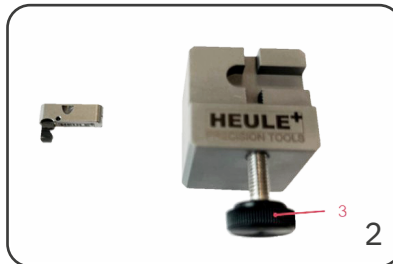

Fully untighten the adjusting screw (3) of the assembly fixture.

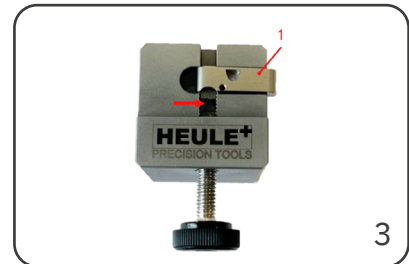

Insert the module with the blade (1) into the assembly fixture, the chamfer blade is pointing towards the adjusting screw.

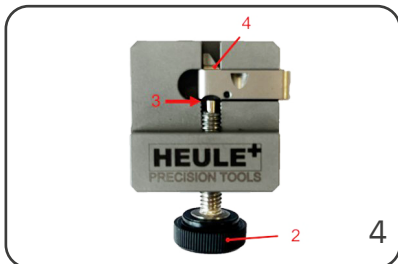

Tighten the adjusting screw (2) of the assembly fixture until the edge of the module (3), the breaking edge (4) of the assembly aid is visible.

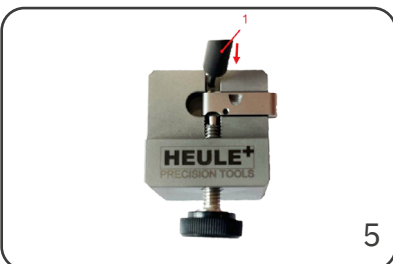

Break off the assembly aid with the mounting pin (1) (apply gentle pressure with the tip on the assembly aid).

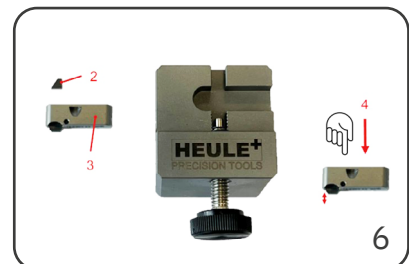

Untighten the adjusting screw, dispose of the assembly aid (2) properly and take out the module (3)

Function control (4): Press the module onto the work surface to check the SNAP function. The chamfering blade automatically moves back to the starting position. In the retracted state, the blade does not protrude from the tool body at the back.

SNAP18 MODULE

BLADE CHANGE – REMOVAL

Assembly fixture LIGHT

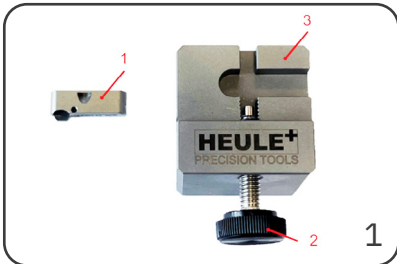

Clean the module **(1)** and fully untighten the adjusting screw **(2)** of the assembly fixture **(3)**.

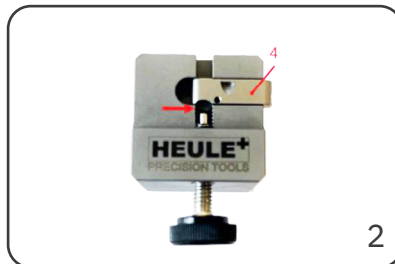

Insert the module with the blade **(4)** into the assembly fixture, the chamfer blade is pointing towards the adjusting screw.



Tighten the adjusting screw **(1)** of the assembly fixture until the blade window clearance of the module.



Untighten the adjusting screw – the blade stays outside the module.

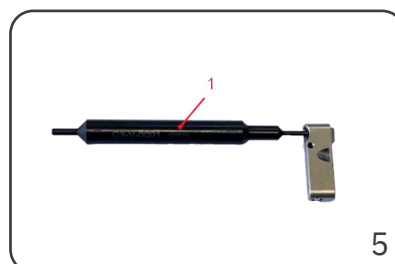

Take out the module and remove the blade by pushing the mounting pin **(1)** from the front side (HEULE logo) towards the blade.

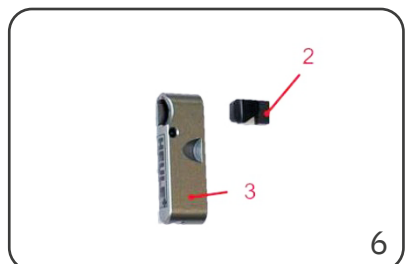

Dispose of the blade **(2)** properly and fit the module **(3)** with a new blade.

Important! Dismantled blades with broken assembly aid can no longer be mounted in modules – risk of injury and damage!

video:

